



REF: # 9721

PILAR DE LA HORADADA



INFO

PRIX:	233.900 €
TYPE:	Appartement
CITY:	Pilar De La Horadada
CHAMBRES:	2
Ba ENFANTS:	2
Built (m2):	81
pas (m2):	21
Terrasse (m2):	29
A ENFANTS:	-
de plante:	-
MESSAGE	-



DESCRIPTION

NEW BUILD RESIDENTIAL OF APARTMENTS GROUND FLOOR IN PILAR DE LA HORADADA. This 81m2 ground floor apartment consists of 2 bedrooms, 2 bathrooms with a private 30m2 terrace and 21m2 garden. The residential has a communal pool and parking space. They are a relaxing combination of natural materials and extensive decoration and perfectly located close to all services, only 300 meters from the town centre of Pilar de la Horadada and less than 3 kilometres from the beach, in the heart of the Costa Blanca. Pilar de la Horadada is a typical Spanish village in the most southern part of the Costa Blanca. There are the beautiful beaches of Torre de la Horadada and Mil Palmeras with fine sand promenade just 5 minutes away. The large main street has supermarkets, lots of shops, restaurants and bars and some lovely squares. Nearby you have a much larger shopping centre, the Plaza Nueva and internationally recognized golf courses such as Lo Romero, Campoamor and Villamartín, among others. The airports of Corvera (Murcia) and Alicante are respectively 40 and 55 minutes away.

CERTIFICAT ÉNERGÉTIQUE

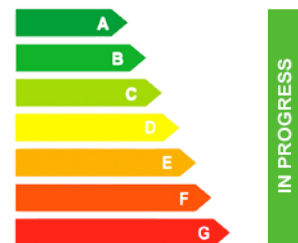

STYLE	CLIMATISATION	DISTANCE :	PARKING PAS. CAR
<ul style="list-style-type: none">moderne	<ul style="list-style-type: none">Central	Beach : 3 Km aéroport: 60 Km	: 1
JARD RIVIÈRE ET TERRASSES N			

- Terrasse ouverte
- Paysage
- clôtures
- Jard RIVER n privée











Planta baja / Ground Floor



VIVIENDA BLOQUE 2 - 37B:

SUPERFICIE ÚTIL	
Salón - Comedor - Cocina.....	34,56 m ²
Dormitorio 1	11,12 m ²
Dormitorio 2.....	10,66 m ²
Baño 1.....	3,20 m ²
Baño 2	3,12 m ²
TOTAL SUPERFICIE ÚTIL	62,66 m²

EXTERIORES	
Terraza 1.....	30,42 m ²
Terraza 2.....	21,16 m ²

SUPERFICIES CONSTRUIDAS	
Superficie construida vivienda	72,00 m ²
Superficie construida terraza 1 (50%).....	5,90 m ²
Superficie construida terraza 2 (50%).....	3,94 m ²

TOTAL SUPERFICIE CONSTRUÍDA	81,84 m²
--	----------------------------

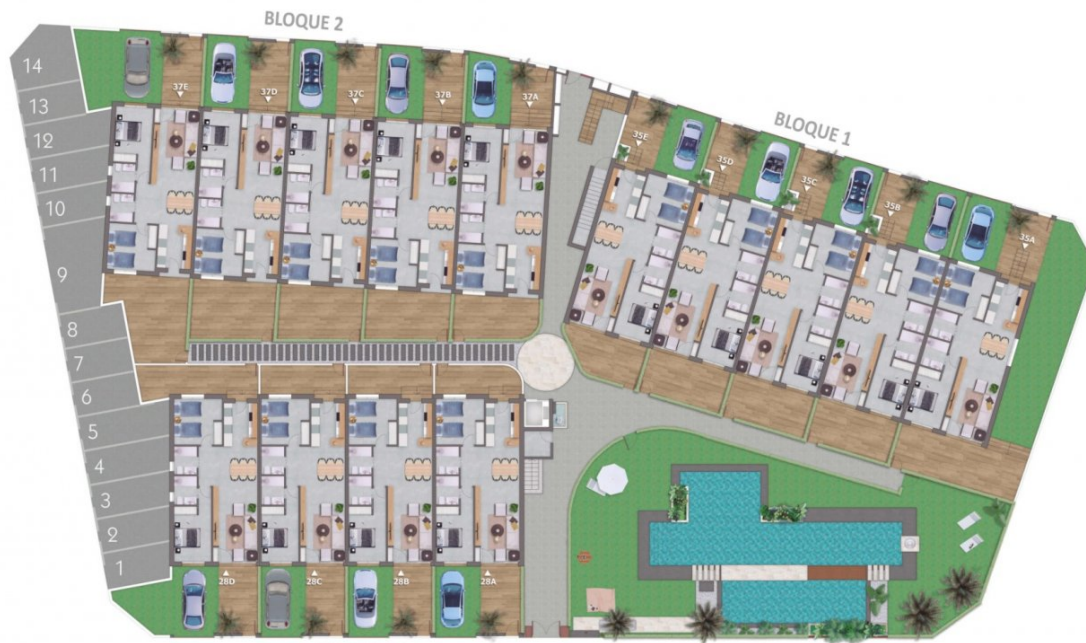

Planta Baja / Ground Floor



Planta Primera / First Floor



Planta Solarium / Topfloor





"OUR EXPERIENCE IS YOUR GUARANTEE"