



REF: # 7753

ALICANTE (GRAN ALACANT)



INFO

PRIX:	225.500 €
TYPE:	Appartement
CITY:	Alicante (Gran Alacant)
CHAMBRES:	2
Ba ENFANTS:	2
Built (m2):	77
pas (m2):	-
Terrasse (m2):	59
A ENFANTS:	
de plante:	-
MESSAGE	-

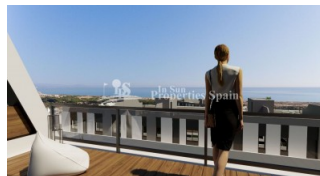

DESCRIPTION

NEW Luxury build development in GRAN ALACANT of 2 and 3 bedroom, 2 bathroom APARTMENTS in an avant-garde design looking to the sea opposite Carabassi beach, which is within a 10minute walk. This is a 2 bedroom, 2 bathroom, 77m2 Apartment with 17m2 terrace and 34m2 private garden. The sleek modern Kitchens are equipped with top quality carpentry with soft close drawers and doors, Silestone type worktop plus a utility with pre-installation for washing machine and tumble dryer. Bathrooms fixed glass shower screens, rainfall effect shower head and porcelain flooring. The homes are ducted hot/cold air conditioning installation and with an aerothermal system for hot water heating. Other features include: Installation, fitted wardrobes, high end interior flooring, anti slip flooring on terraces and solarium and top quality PVC windows, covered parking space and storeroom assigned to each home. The development offers communal swimming pool with Jacuzzi, gym and children's playground, as well as bicycle parking, designer garden area and benches to stroll and relax. The development is designed for the whole family, set within a unique ecosystem of dunes

and pines groves, and next to Clot del Galvany, classified a virgin natural area. Next to an array of amenities including; banks, shopping centre, library, police station, sports centre, medical centre, post office and many restaurants. 5 minutes drive from Gran Alacant Centro Commercial and only 15 minutes drive from Alicante Airport (ALC). The historic City of Alicante is just 25 minutes away and Murcia City is less than an hour away. Delivery 2021 "Price" for 2bedr-2 bathr. from 225.500.-€ to 312.595.-€ and 3bedr-2 bathr. from 287.345.-€ to 357.035.-€



STYLE	VIEW	CLIMATISATION	DISTANCE :
<ul style="list-style-type: none">moderne	<ul style="list-style-type: none">PanoramicoOceanune vue sur la montagne	<ul style="list-style-type: none">Central	Beach : 500 m aéroport: 10 Km : 1 Km
POSITION	MEUBLÉ	PARKING PAS. CAR	ZONES
Ouest du Sud-Est	<ul style="list-style-type: none">Vide	Garage no. Car : 1	<ul style="list-style-type: none">stockage
ÉTAGE	CUISINE	JARD RIVIÈRE ET TERRASSES N	EXTRA
<ul style="list-style-type: none">tuilesStone	<ul style="list-style-type: none">cuisinecuisine équipéegranit	<ul style="list-style-type: none">Terrasse couverteTerrasse ouverteFeux extérieursclôturesmurs en pierrehayonJard RIVER n privéeJard RIVER Communauté	<ul style="list-style-type: none">intégréDouble vitrage











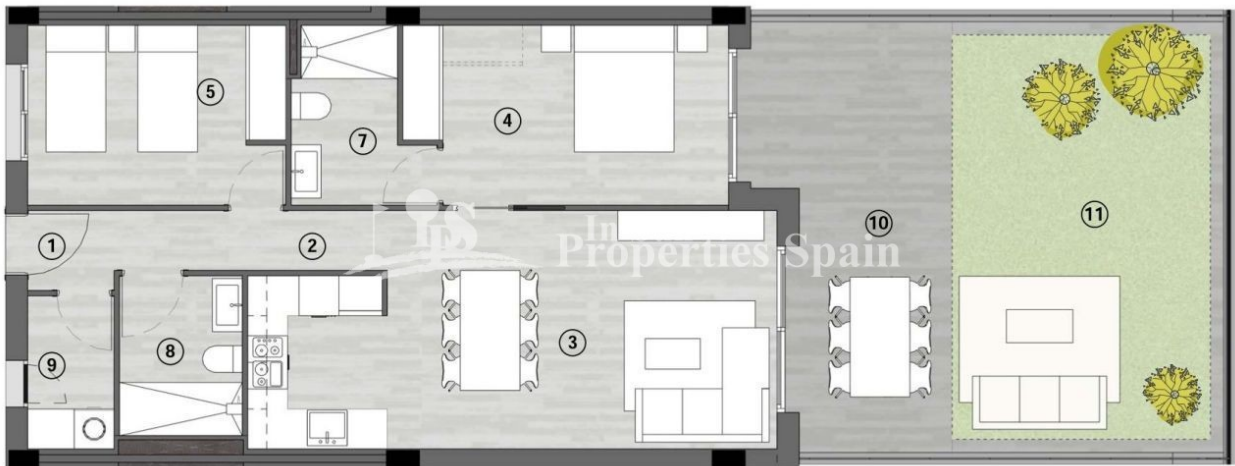











"OUR EXPERIENCE IS YOUR GUARANTEE"