



REF: # 12219

PILAR DE LA HORADADA (TORRE DE LA HORADADA)



#### INFO

**PRIX:** 475.000 €

**TYPE:**

**CITY:** Pilar De La Horadada (Torre de la Horadada)

**CHAMBRES:** 3

**Ba ENFANTS:** 2

**Built ( m2 ):** 114

**pas ( m2 ):** -

**Terrasse ( m2 ):** 97

**A ENFANTS:** -

**de plante:** -

**MESSAGE** -



#### DESCRIPTION

NEW BUILD RESIDENTIAL COMPLEX IN TORRE DE LA HORADADA - only 300m to the beach! New Build residential complex of apartments, penthouses and bungalows with 2 and 3 bedrooms, 2 bathrooms in Torre de la Horadada only 300m from the beach. Bungalows on the ground floor with private gardens, penthouses and bungalows on the top floor with private solarium. All of them with fitted kitchen with high and low furniture. There is also a laundry area and pre-installation for air conditioning. The residential complex consists of communal swimming pools and garden areas. All properties has private parking. Torre de la Horadada is located south of Alicante in a beautiful location on the coast. The beautiful beaches of Torre de la Horadada and Mil Palmeras have fine sand beautiful promenade. There are lots of restaurants, bars and shops, also water sports, diving and snorkelling. It is well connected just 40 minutes from Alicante and Murcia's Corvera airports, with large commercial shopping centres and multiple golf courses all within easy reach.

#### CERTIFICAT ÉNERGÉTIQUE



<b>STYLE</b>	<b>VIEW</b>	<b>CLIMATISATION</b>	<b>DISTANCE :</b>
<ul style="list-style-type: none"><li>moderne</li></ul>	<ul style="list-style-type: none"><li>Panoramico</li></ul>	<ul style="list-style-type: none"><li>Central</li></ul>	Beach : 200 m aéroport: 50 Km : 3 Km
<b>MEUBLÉ</b>	<b>PARKING PAS. CAR</b>	<b>ÉTAGE</b>	<b>CUISINE</b>
<ul style="list-style-type: none"><li>Vide</li></ul>	: 1	<ul style="list-style-type: none"><li>tuiles</li><li>Stone</li></ul>	<ul style="list-style-type: none"><li>cuisine</li></ul>
<b>JARD RIVIÈRE ET TERRASSES N</b>	<b>EXTRA</b>		
<ul style="list-style-type: none"><li>Terrasse ouverte</li><li>arbres fruitiers</li><li>clôtures</li></ul>	<ul style="list-style-type: none"><li>intégré</li><li>Alarme</li><li>Porte de sécurité</li><li>Double vitrage</li><li>Laundry</li><li>Elevator</li></ul>		













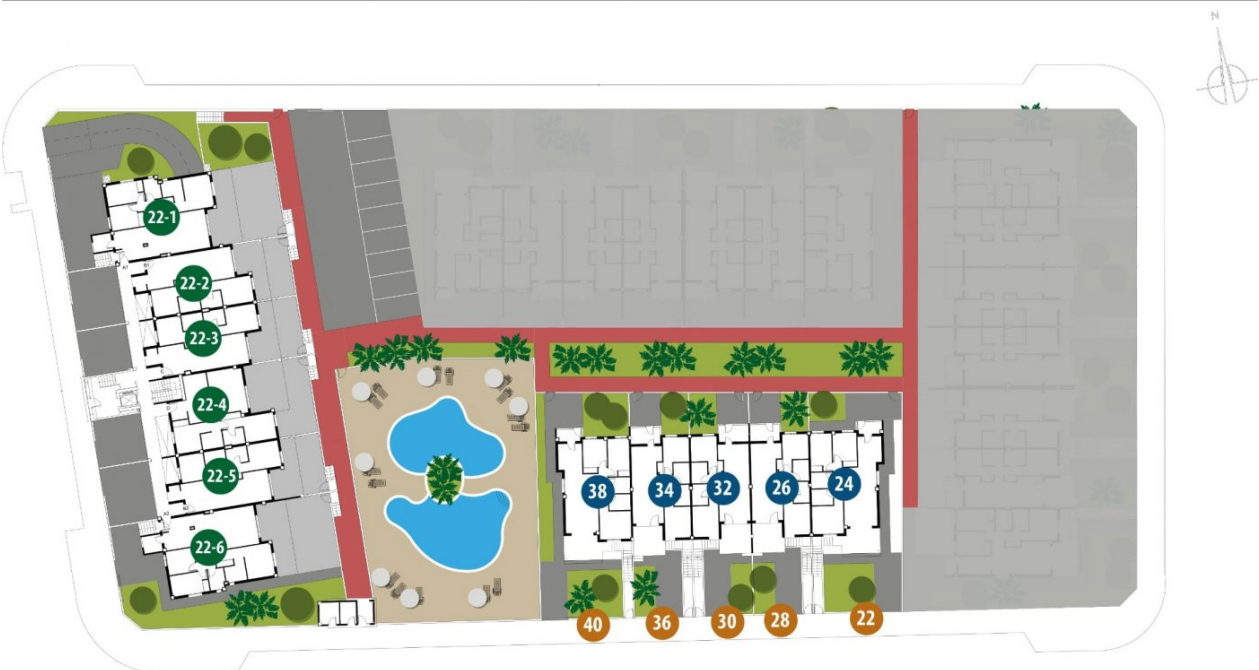

















***"OUR EXPERIENCE IS YOUR GUARANTEE"***