



REF: # 11358

ORIHUELA COSTA



#### INFO

PRIX: 286.000 €

TYPE:

CITY: Orihuela Costa

CHAMBRES: 3

Ba ENFANTS: 2

Built ( m2 ): 97

pas ( m2 ): -

Terrasse ( m2 ): -

A ENFANTS: -

de plante: -

MESSAGE -



#### DESCRIPTION

**NEW BUILD APARTMENTS IN LAS FILIPINAS** New Build Residential complex in Las Filipinas. The gated community has a total of 94 apartments of 2 and 3 bedrooms and 1 or 2 bathrooms. Open plan kitchen with living room and terraces. The communal areas are roughly 3.300 m2 big and 2 pools, jacuzzi and 2 boules courts. W-Fi will be available in all communal areas. This residential located in the area of Villamartin Golf (Orihuela Costa), and is designed to fulfil the needs of those who are looking for the Mediterranean lifestyle, in a quiet area in a well established area and yet close to the sea (8 minutes) and very close to all amenities. Complex located 40 minutes from Alicante airport and 1 hour Murcia - Corvera airport.

#### CERTIFICAT ÉNERGÉTIQUE



VIEW

- Panoramico

























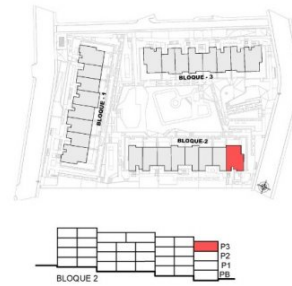
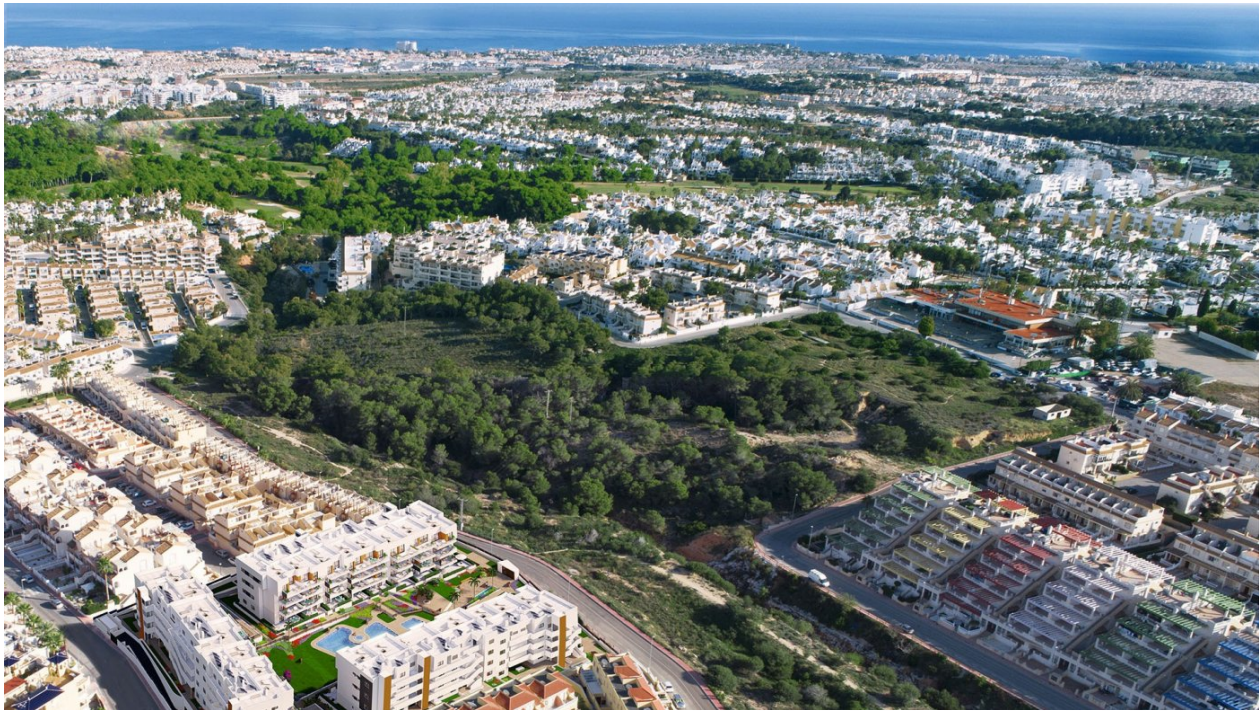

m²	SUPERFICIES ÚTILES / FLOOR AREA / SURFACES UTILES	TIPO / TYPE / TYPE
1	VESTIBULO / HALL / ENTRÉE	E3a
2	DISTRIBUIDOR / CORRIDOR / CIRCULATION	2,95 m²
8	SALON - COFIDOR COCINA / LIVING-DINING ROOM- KITCHEN / SALON-SALLE A MANGER- CUISINE	28,15 m²
7	GALLERIA / GALLERY / GALERIE (1076)	2,34 m²
9	DORMITORIO 1 / BEDROOM 1 / CHAMBRE 1	13,34 m²
10	DORMITORIO 2 / BEDROOM 2 / CHAMBRE 2	8,79 m²
11	DORMITORIO 3 / BEDROOM 3 / CHAMBRE 3	8,79 m²
12	BANO 1 / BATHROOM 1 / SALLE DE BAIN 1	3,78 m²
13	BANO 2 / BATHROOM 2 / SALLE DE BAIN 2	3,49 m²
14	TRASTERO / STOREROOM / CAGIBI	1,30 m²
15	ESCALERA / STAIRS / ESCALIERS	1,89 m²
TOTAL SUP. ÚTILES / TOTAL FLOOR AREA / TOTAL SURFACES UTILES		77,11 m²
SUP. CONSTRUIDA INTERIOR / BUILT INTERIOR AREA / SURFACE CONSTRUITE IN TERIEUR		93,51 m²
22	SUP. CONSTRUIDA TERRAZA DESCUBIERTA 1 / BUILT OPEN 1 AREA / SURFACE CONSTRUITE TERRASSE DÉCOUVERTE	13,13 m²
20	SUP. CONSTRUIDA SOLARIUM 1/ BUILT SOLARIUM 1 AREA/ SURFACE CONSTRUITE SOLARIUM	24,19 m²
TOTAL SUP. CONSTRUIDA PRIVADA / TOTAL BUILT PRIVATE AREA / TOTAL SURFACE CONSTRUITE PRIVATIVE		180,83 m²



TIPO/TYPE/TYPE **E3a**

0 1 m 3 m 5 m



52	Piscine adultes	Adult pool	Piscine enfants	78	Buanderie	Mailboxes
65	Piscine infanterie	Children pool	Piscine enfants	81	Salle appartements	Parking rail
66	Entrée personnel	Entrance	Entrée	82	Accès personnel à appartements	Personnel access to the carport
67	Entrée appartements	Parking entrance	Entrée parking	90	Douches	Shower
74	Jeuquet	Jeuquet	Jeuquet	114	Jouets piscine	Games piscine
75	Appartements locatifs	Bike parking	Parking à vélos	121	Centre de transformation	Distribution substation
						Transformateur











***"OUR EXPERIENCE IS YOUR GUARANTEE"***