



REF: # 11351

ORIHUELA COSTA



INFO

PRIX: 234.000 €

TYPE:

CITY: Orihuela Costa

CHAMBRES: 2

Ba ENFANTS: 1

Built (m2): 72

pas (m2): -

Terrasse (m2): -

A ENFANTS: -

de plante: -

MESSAGE -



DESCRIPTION

NEW BUILD APARTMENTS IN LAS FILIPINAS New Build Residential complex in Las Filipinas. The gated community has a total of 94 apartments of 2 and 3 bedrooms and 1 or 2 bathrooms. Open plan kitchen with living room and terraces. The communal areas are roughly 3.300 m2 big and 2 pools, jacuzzi and 2 boules courts. W-Fi will be available in all communal areas. This residential located in the area of Villamartin Golf (Orihuela Costa), and is designed to fulfil the needs of those who are looking for the Mediterranean lifestyle, in a quiet area in a well established area and yet close to the sea (8 minutes) and very close to all amenities. Complex located 40 minutes from Alicante airport and 1 hour Murcia - Corvera airport.

CERTIFICAT ÉNERGÉTIQUE



VIEW

- Panoramico

PROPERTY GALLERY













52	Piscina adultos	Adult pool	Piscina adultos	78	Buñuelos	Mallowes	Berles aux lettres
65	Piscina infantil	Children pool	Piscina infantil	81	Sellole apartamentos	Parking rail	Sortie parking
66	Entrada peatonal	Entrance	Entrée	82	Acceso peatonal a apartamentos	Pedestrian access to the carpark	Entrée piétonne au parking
67	Entrada apartamentos	Parking entrance	Entrée parking	83	Duchas	Showers	Douche
74	Jenutzi	Jenutzi	Jenutzi	114	Juegos peñales	Games penance	Jeux pénitence
75	Aparcamiento bici	Bike parking	Parking a vélos	121	Centro de transformación	Distribution substation	Transformateur

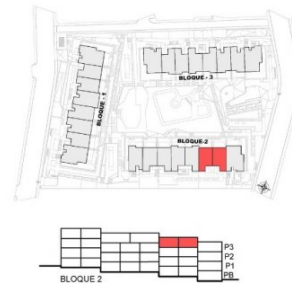

nº	SUPERFICIES ÚTILES / FLOOR AREA / SURFACES UTILES	TIPO / TYPE / TYPE
1	VESTIBULO / HALL / ENTRÉE	B3
2	DISTRIBUIDOR / CORRIDOR / CIRCULATION	1,58 m²
8	SALON-COMEDOR-COCINA / LIVING-DINING ROOM- KITCHEN / SALON SALLE A MANGER- CUISINE	26,82 m²
7	GALERIA / GALLERY / GALLERIE (LOBBY)	2,24 m²
9	DORMITORIO 1 / BEDROOM 1 / CHAMBRE 1	11,15 m²
10	DORMITORIO 2 / BEDROOM 2 / CHAMBRE 2	9,23 m²
12	BANO 1 / BATHROOM 1 / SALLE DE BAINS 1	5,47 m²
15	ESCALERA / STAIRS / ESCALIER	3,56 m²
TOTAL SUP. UTILES / TOTAL FLOOR AREA / TOTAL SURFACES UTILES		61,24 m²
SUP. CONSTRUIDA INTERIOR / BUILT INTERIOR AREA / SURFACE CONSTRUITE IN TIERIEUR		71,98 m²
22	SUP. CONSTRUIDA TERRAZA DESCUBERTA 1 / BUILT OPEN 1 AREA / SURFACE CONSTRUITE TERRASSE DÉCOUVERTE	13,38 m²
20	SUP. CONSTRUIDA SOLARIUM 1 / BUILT SOLARIUM 1 AREA / SURFACE CONSTRUITE SOLARIUM	43,08 m²
TOTAL SUP. CONSTRUIDA PRIVADA / TOTAL BUILT PRIVATE AREA / TOTAL SURFACE CONSTRUITE PRIVATIVE		128,39 m²

TIPO/TYPE/TYPO B3









"OUR EXPERIENCE IS YOUR GUARANTEE"