



REF: # 11292

TORRE PACHECO (ROLDAN)



INFO

| | |
|-------------------------|------------------------|
| PRIX: | 325.950 € |
| TYPE: | Villa |
| CITY: | Torre Pacheco (Roldan) |
| CHAMBRES: | 3 |
| Ba ENFANTS: | 2 |
| Built (m2): | 80 |
| pas (m2): | 230 |
| Terrasse (m2): | 79 |
| A ENFANTS: | - |
| de plante: | - |
| MESSAGE | - |

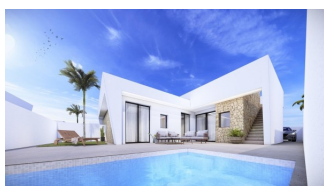
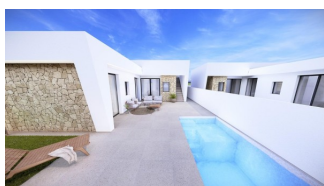

DESCRIPTION

NEW BUILD SEMI-DETACHED VILLAS IN ROLDAN New Build 3 bedroom villas with parking to the front, feature stone walling, rear private swimming pool, large roof solarium and a storage room in Roldan, Torre-Pacheco. The villas are designed on one level with elevated ceiling to the kitchen area, each villa boasts wrap around terrace / sun zones on the ground floor and a large private solarium on the first floor to enjoy hours of sunshine, all year round. 3 bedrooms (master bedroom en-suite) and separate family bathroom... designed with a contemporary 'eco' style and open plan concept, comprising a fitted kitchen and lounge-dining room, a storage room to the front and a private summer patio area. The villas are equipped with a rear private swimming pool with outdoor shower, solarium, terrace areas, fully fitted kitchen and bathrooms with led mirror, lined wardrobes with drawers, interior/exterior lighting, pre installed air-conditioning. Feature angled walls and stone cladding to the front and stairwell, really makes this villa pop with style. The development is located in a residential area of Roldan, surrounded by services, parks, sports facilities, two Golf Courses

and only 12 minutes from the stunning beaches of the Mediterranean and the Mar Menor. A select signature style development – just 20 one level contemporary villas – All enjoying generous plot sizes, with private swimming pool and roof solarium. Roldan itself is a traditional town with all the local amenities you will need including Supermarkets, Restaurants, Bars, Health Clinic, Pharmacy, Police Station, Petrol Station, Mechanics, Dentists, Doctors and more. The nearby golf resorts of La Torre, [amp;] Terrazas are easily accessible, Corvera Airport is 15 minutes away [amp;] the beaches of the Mar Menor just 20 minutes drive.



VIEW

- Panoramico

CLIMATISATION

- Central

PARKING PAS. CAR

: 1

**JARD RIVIÈRE ET
TERRASSES N**

- clôtures
- Jard RIVER n privée







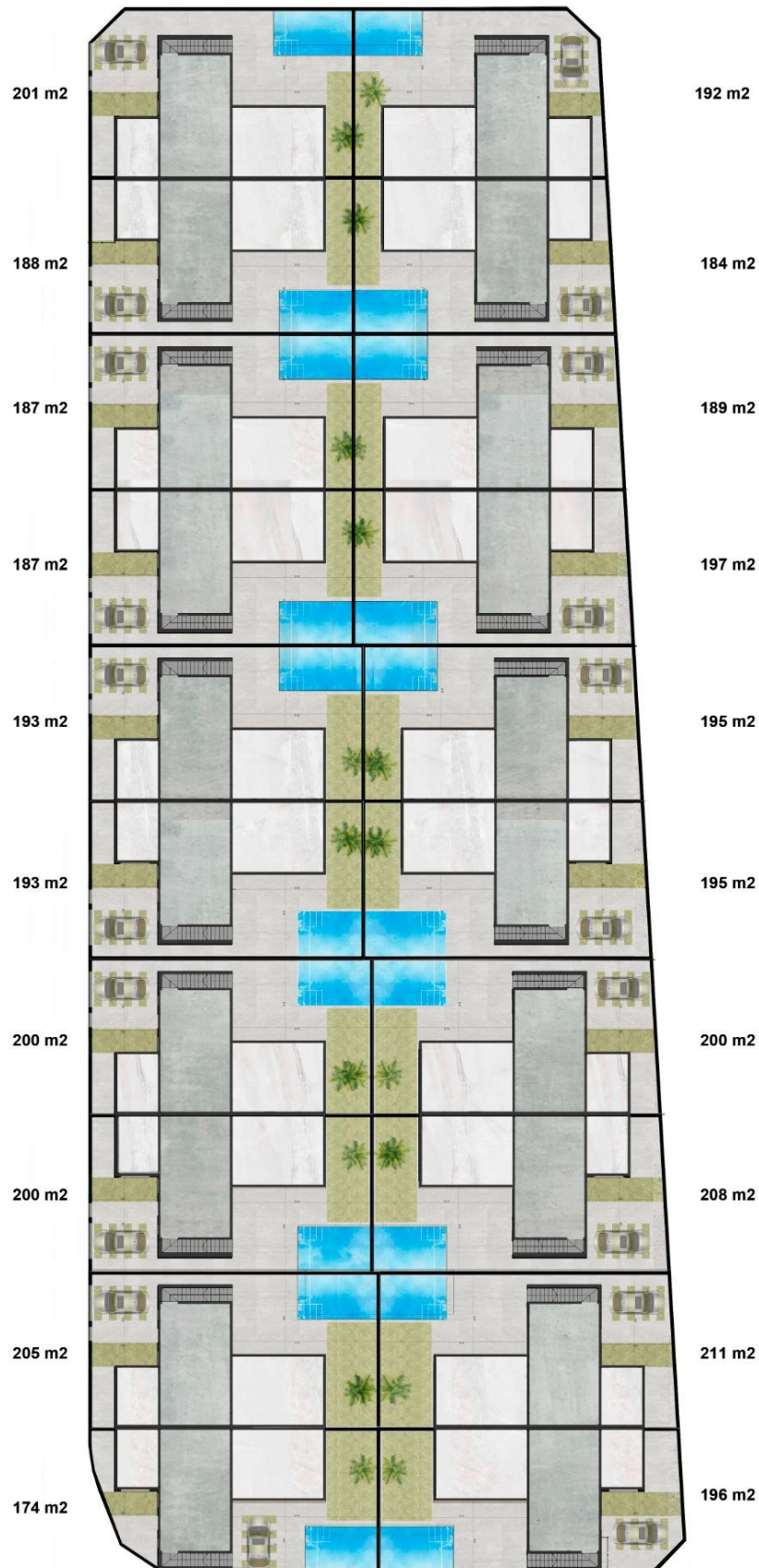

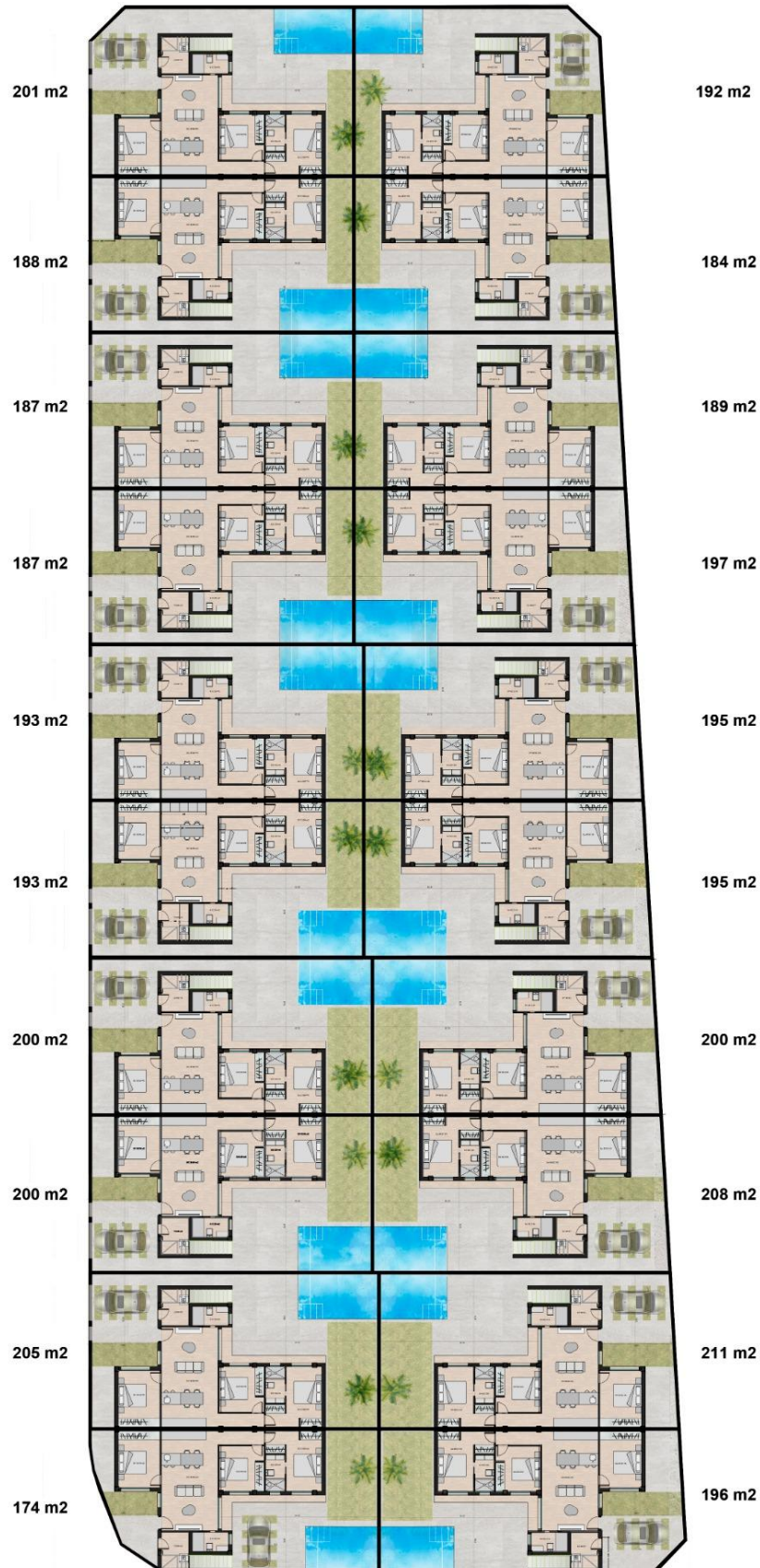



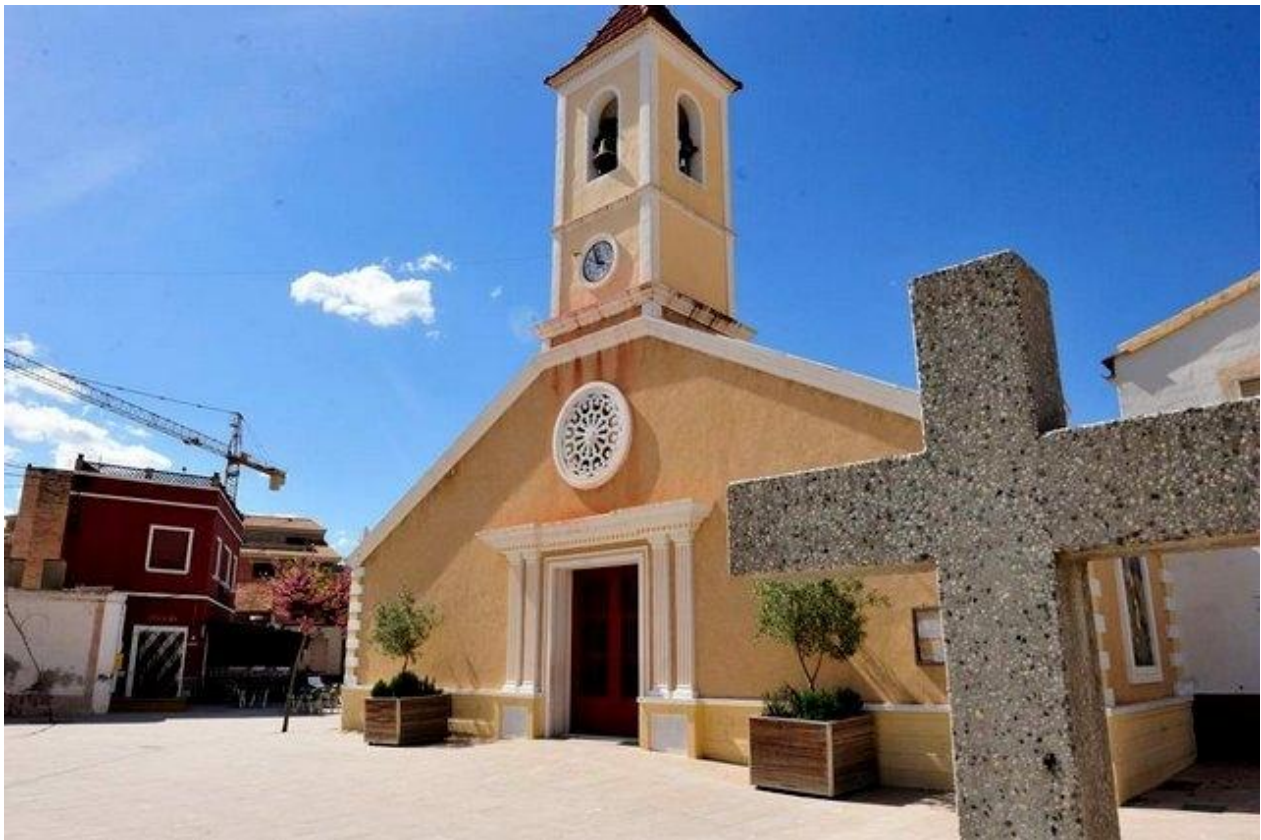





"OUR EXPERIENCE IS YOUR GUARANTEE"